



DELANEY®

BRAVURA • DELANEY • CALLAN

PRODUCT CATALOG



Premium Hardware with Exceptional Service for
Single-Family, Multi-Family, & Commercial Buildings



DELANEY®

The Delaney Hardware Difference

Our unwavering commitment and passion to provide you with superior quality hardware and exceptional service distinguishes us from the rest of the industry. Our mission is to make furnishing your home's door hardware refreshingly easy.

Founded over 30 years ago on strong family values, we understand the attention to detail needed to consistently and reliably deliver stylish, durable and secure hardware. We offer three brand tiers of door hardware as well as barndoor, trim and bath hardware. Specializing in providing hardware solutions for residential homes, multi-family buildings, and commercial projects, we provide exceptional service, accurate and on-time deliveries, and superior value for all of your hardware needs.

Delaney Hardware is part of the Sargent and Greenleaf (S&G) family of brands. For more information, please visit:

www.DelaneyHardware.com

TABLE OF CONTENTS

Door Hardware

Bravura

Entrance Hardware	
Handlesets.....	7-8
Deadbolts.....	9
Solid Brass Knobs & Levers	
Solid Brass Knobs	11-12
Crystal Knobs	12
Solid Brass Levers.....	13
Solid Zinc Levers.....	16

Delaney

Sandcast	
Handlesets.....	19-20
Knobs.....	20
Entrance Hardware	
Handlesets.....	21-22
Deadbolts.....	22
Knobs & Levers	
Grade 2 Knobs & Levers	24
Grade 3 Knobs.....	26
Grade 3 Levers.....	28

Callan

Entrance Hardware	
Handlesets.....	30
Deadbolts.....	30
Knobs & Levers	
Knobs.....	31
Levers	32

Electronic Locks

Digital locks	33-34
---------------------	-------

Barndoor Hardware

Flat Track Series.....	36-37
Pulls & Handles	38

Bath Hardware

1100 series	40
900 series	40
800 series	41
700 series	41
600 series	42
500 series	42
400 series	43
300 series	43
200 series	44
Accessories.....	44

Trim Hardware & Hinges

Pocket Door Locks.....	47
Door Knockers & Viewers	48
Plates & Pulls	48
Exterior Shutter Hardware	49
Handrail Brackets.....	50
Flush Bolts.....	50
Door Stops	51-52
Closet Hardware.....	53
Hinges.....	54

Multi-Family/Commercial

Multi-Family Smartlock	56
Locksets	57-58
Deadbolts	59-60
Exit Devices	61-62
Exterior Trims	63
Door Closers	64

Reference Guide of Finishes	65
-----------------------------------	----



DOOR HARDWARE

First impressions are everything... Your home's first impression starts at your front door. It should express your unique style with the utmost quality, durability and security.

At Delaney, we make it our mission to provide the best door hardware for every homeowners distinct needs. We have three brand levels to select from with a wide array of design styles so your front door hardware will make the right first impression. You will also have peace of mind knowing that all of our brand product lines consist of secure internal mechanics regulated to ANSI rated standards.

Bravura[®]

Finest quality, solid forged-brass designer line from Delaney with luxurious finishes. You will be able to feel the difference every time you open the door.

DELANEY[®]

Premium door hardware with a variety of styles and finishes including the unique Sandcast collection.

CALLAN[®]

High quality door hardware offered in a wide variety of finishes. Callan is the preferred hardware brand for builders.

Bravura®

Add A Touch of Luxury

There is something distinctive about the feel of solid, forged-brass that can't be duplicated. It's heavy and strong, yet smooth and comfortable to the touch. Bravura's grade 2, solid forged-brass product line is never cast, hollow, or stamped. To enhance its beauty, each handleset, knob and lever is hand-finished to deliver a luxurious appearance that is both beautiful and durable... Providing long lasting quality you can feel.

Entrance Hardware

Handlesets	7-8
Deadbolts	9

Solid Brass (900 Series) Knobs & Levers

Solid Brass Forged Knobs	11-12
Crystal Knobs	12
Solid Brass Forged Levers	13

Solid Zinc (300 Series)

Levers.....	16
-------------	----

ENTRANCE HANDLESETS



915

Shown in US15
Also available in: US10B, US19, US26

980G-1

Shown in US10B
Also available in: US15, US19, US26

ENTRANCE HANDLESETS



913

Shown in US15
Also available in: US10B, US19, US26



971

Shown in US10B
Also available in: US15, US19, US26

INTERIOR OPTIONS



**615 Interior Plate &
906 Interior Knob**

Shown in US15
Also available in:
US10B, US19, US26



**615 Interior Plate &
939 Interior Lever**

Shown in US15
Also available in:
US10B, US19, US26

HANDLESET FINISHES



US10B
OIL RUBBED
BRONZE



US15
SATIN
NICKEL



US19
BLACK



US26
POLISHED
CHROME

DEADBOLTS



Outside

Inside

Outside

Inside

910-1 Single Keyed
Shown in US10B
Also available in:
US15, US19, US26

910-2 Single Keyed
Shown in US15
Also available in:
US10B, US19, US26



Outside

Inside

910-6 Single Keyed
Shown in US26
Also available in:
US10B, US15, US19



Outside

Inside

910-7 Single Keyed
Shown in US15
Also available in:
US10B, US19, US26

DEADBOLT FINISHES



US10B
OIL RUBBED
BRONZE



US15
SATIN
NICKEL



US19
BLACK



US26
POLISHED
CHROME

SOLID FORGED BRASS (900 SERIES)



The Bravura grade 2, solid forged-brass knobs and levers provide the ultimate luxury in look and feel with timeless durability. Each piece combines a stunning designer finish, high-end style and smooth mechanics that delivers a one-of-a-kind experience that cannot be replicated.

Our solid-forged brass collection is custom assembled to your select style in rosette, knobs, levers, and finishes; tailored to your exact taste.

SOLID FORGED KNOBS.....	11-12
CRYSTAL KNOBS.....	12
SOLID FORGED LEVERS.....	13
SOLID ZINC.....	16

SOLID FORGED BRASS KNOBS

905 KNOB

905 KNOB FINISHES

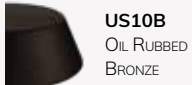

US10B
OIL RUBBED
BRONZE



US15
SATIN
NICKEL



US19
BLACK



US26
POLISHED
CHROME

905-6

Shown in US15
Also available in:
US10B, US19, US26



905-7

Shown in US15
Also available in:
US10B, US19, US26



905G-1

Shown in US15
Also available in:
US10B, US19, US26



905G-2

Shown in US15
Also available in:
US10B, US19, US26



906 KNOB

906 KNOB FINISHES



US10B
OIL RUBBED
BRONZE



US15
SATIN
NICKEL



US19
BLACK



US26
POLISHED
CHROME

906-6

Shown in US15
Also available in:
US10B, US19, US26



906-7

Shown in US15
Also available in:
US10B, US19, US26



906G-1

Shown in US15
Also available in:
US10B, US19, US26



906G-2

Shown in US15
Also available in:
US10B, US19, US26



SOLID FORGED BRASS KNOBS

936 KNOB

936 KNOB FINISHES



936-6
Shown in US15
Also available in:
US10B, US19, US26



936-7
Shown in US15
Also available in:
US10B, US19, US26



936G-1
Shown in US15
Also available in:
US10B, US19, US26



936G-2
Shown in US15
Also available in:
US10B, US19, US26



925 CRYSTAL KNOB

925 KNOB FINISHES



925-6
Shown in US15
Also available in:
US10B, US19, US26



925-7
Shown in US15
Also available in:
US10B, US19, US26



925G-1
Shown in US15
Also available in:
US10B, US19, US26



925G-2
Shown in US15
Also available in:
US10B, US19, US26



SOLID FORGED BRASS LEVERS

939 LEVER

939 LEVER FINISHES

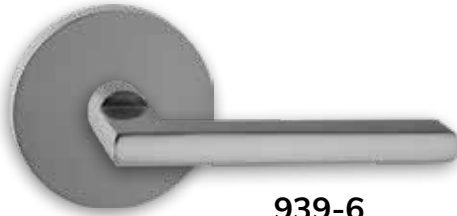

939-6
Shown in US15
Also available in:
US10B, US19, US26

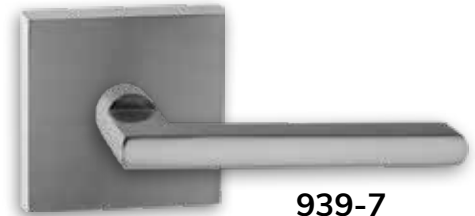

939-7
Shown in US15
Also available in:
US10B, US19, US26



939G-1
Shown in US15
Also available in:
US10B, US19, US26



939G-2
Shown in US15
Also available in:
US10B, US19, US26

943 LEVER

943 LEVER FINISHES

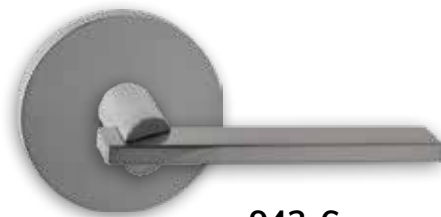

943-6
Shown in US15
Also available in:
US10B, US19, US26



943-7
Shown in US15
Also available in:
US10B, US19, US26



943G-1
Shown in US15
Also available in:
US10B, US19, US26



943G-2
Shown in US15
Also available in:
US10B, US19, US26

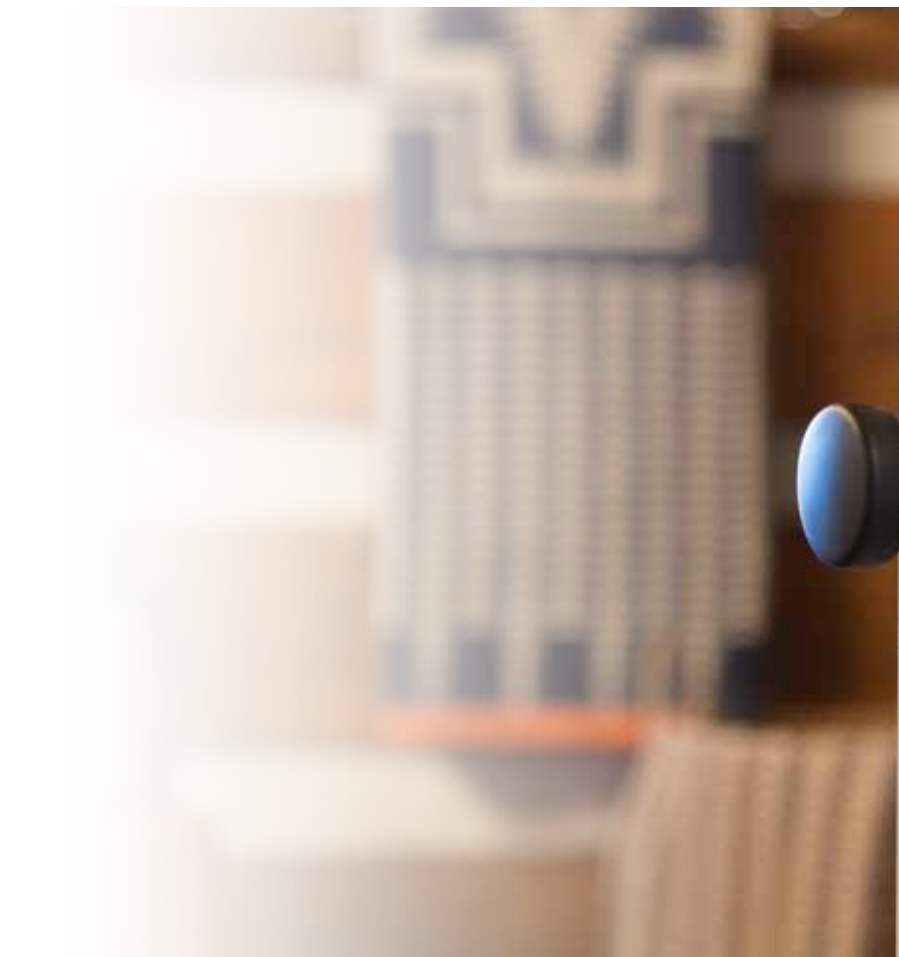

SOLID ZINC (300 SERIES)

Our solid zinc (300 Elite series) door hardware is designed to provide simple elegance and style. This collection is manufactured to strict specifications and tight tolerances with the best materials to create top quality door hardware that is tested to ensure long-lasting smooth and firm operation. Our solid zinc collection is a finished product line which cannot be customized like our solid forged brass collection. The beauty of our solid zinc series provides any home or dwelling with a stylish upgrade.



SOLID ZINC (300 SERIES)

Elite Series



333RC
Shown in US15
Also available in: US10B, US19



334SB
Shown in US15
Also available in: US10B, US19



333SC
Shown in US10B
Also available in: US15, US19



333B
Shown in US15
Also available in: US10B, US19

DEADBOLTS

Outside



Inside



310B Deadbolt
Shown in US10B
Also available in: US15, US19

Outside



Inside



310RC Deadbolt
Shown in US10B
Also available in: US15, US19

Outside



Inside



310SC Deadbolt
Shown in US15
Also available in: US10B, US19

AVAILABLE SOLID ZINC FINISHES



US10B
OIL RUBBED
BRONZE



US15
SATIN
NICKEL



US19
BLACK



DELANEY®

Premium Door Hardware

Delaney's superior quality door hardware combines stylish designs with premium finishes including our unique Sandcast collection for homeowners, builders and installers. Express your one-of-a-kind style with the utmost quality, durability and security when you use our grade 2 & 3 ANSI rated hardware.

Sandcast Collection

Handlesets	19-20
Knobs	20

Entrance Hardware

Handlesets	21-22
Deadbolts	22

Knobs & Levers

Grade 2 Knobs & Levers	24
Grade 3 Knobs	26
Grade 3 Levers.....	28

SANDCAST COLLECTION



CASTILLE HANDLESET
Shown in ABR

SANDCAST COLLECTION



CORDOBA® HANDLESET
Shown in ABK

DEADBOLTS



SQUARE DEADBOLT
Shown in ABK

KNOBS



SORRENTO® KNOB
Shown in ABK



TULUM® KNOB
Shown in ABK

ENTRANCE HANDLESETS



**AVINO
HANDLESET**
Shown in US15

**KELLINGTON
HANDLESET**
Shown in US12P
Also available in: US15, US19

**WICKLOW®
HANDLESET**
Shown in US15

ENTRANCE HANDLESETS



**TRALEE®
HANDLESET**
Shown in US12P
Also available in US15

DEADBOLTS



GRADE 2 DEADBOLT
Shown in US15
Also available US3, US19, US12P



GRADE 3 DEADBOLT
Shown in US15
Also available in US12P,
US19, US26, US32D



GRADE 3 SQUARE DEADBOLT
Shown in US26
Also available in: US15, US12P, US19



GRADE 3 ROUND DEADBOLT
Shown in US15

INTERIOR OPTIONS



VIDA SQUARE
Shown in US15
Also available in US15



OLIVIA
Shown in US15
Also available in US19, US12P

HANDLESET
FINISHES



**US12P
TUSCANY
BRONZE**



**US15
SATIN
NICKEL**



**US19
BLACK**



GRADE 2 KNOBS & LEVERS



ORLYN
Shown in US12P
Also available in: US15



AUBRYN
Shown in US12P
Also available in: US15, US19



LASHBROOK
Shown in US15
Also available in US12P, US19



MIRCET
Shown in US15
Also available in US19



VONCET
Available in US15

AVAILABLE
FINISHES



US12P
TUSCANY
BRONZE



US15
SATIN
NICKEL



US19
BLACK



GRADE 3 KNOBS



DERBY™
Shown in US12P
Also available in US15



OLIVIA®
Shown in US12P
Also available in US19, US32D



BELTON®
Shown in US32D
Also available in US19, US12P



GALWAY®
Shown in US32D
Also available in US3

AVAILABLE FINISHES



US3
POLISHED
BRASS



US12P
TUSCANY
BRONZE



US15
SATIN
NICKEL

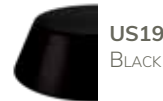

US19
BLACK



US32D
STAINLESS
STEEL



CIRA
with Round Rosette
Shown in US26
Also available in US15



VIDA
with Round Rosette
Shown in US15
Also available in US26, US12P, US19



VIDA
with Square Rosette
Shown in US26
Also available in US15, US12P, US19



KIRA®
Shown in US15
Also available in US26

GRADE 3 LEVERS



DAYTON
Shown in US19
Also available in US15, US26



KERRY
Shown in US12P
Also available in US15



LOGAN
Shown in US12P
Also available in US15, US19, US26



VL LEVER
Available in US15



HK LEVER
Shown in US15
Also available in US26, US12P, US19



RD LEVER
Shown in US15
Also available in US26, US19



MILTON®
Shown in US26
Also available in US12P, US15, US26D



ET LEVER
Shown in US15
Also available in US26D



TULINA
with Round Rosette.
Shown in US15
Also available in US26, US19



TULINA
with Square Rosette
Shown in US15
Also available in US26, US19

AVAILABLE FINISHES

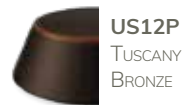

US12P
TUSCANY
BRONZE



US15
SATIN
NICKEL



US19
BLACK



US26
POLISHED
CHROME



CALLAN®

Callan offers a full line of high-quality door hardware in a wide variety of finishes for all residential and multi-family homes. With consistent premium security mechanics to ANSI rated standards, Callan offers the best value for the cost in entrance handlesets, deadbolts, interior hardware and door accessories.

AVAILABLE CALLAN HARDWARE FINISHES



US3
POLISHED
BRASS



US5
ANTIQUE
BRASS



US10
OIL RUBBED
BRONZE



US10B
AGED
BRONZE



US15
SATIN
NICKEL



US15A
ANTIQUE
NICKEL



US26
POLISHED
CHROME



AS
ANTIQUE
SILVER



US19
BLACK

For Reference Guide for all Finishes,
Please see Page 65

ENTRANCE HANDLESETS



**BRIONA®
HANDLESET**
Shown in US10BE
Also available in US19



**VISCONTI®
HANDLESET**
Shown in US15
Also available in
US10BE, US19
(Dummy available
in US19 only)



**CHATHAM®
HANDLESET**
Shown in US10B
Also available in
US10BE, US15, US19

**COLTON®
HANDLESET**
Grade 2 & 3
Shown in US10BE
Also available in
US10B, US15, US19

DEADBOLTS



**SQUARE
DEADBOLT**
Shown in US10BE
Also available in US15, US19



**ROUND
DEADBOLT**
Grade 2 & 3
Shown in US15
Also available in US3, US5,
US15A, US26, US10B,
US10BE, AS, US19

GRADE 2 & 3 KNOBS



SAXON®
Grade 2 & 3
Shown in US15
Also available in US3, US15A,
US5, US26, US10B, US10BE, US19, AS



CARLYLE®
Grade 2 & 3
Shown in US10BE
Also available in US3, US15, US15A, AS,
US10B, US19



FAIRFIELD®
Grade 2 & 3
Shown in US10B
Also available in US3, US5,
US15, US10BE, US19



BRAYDEN®
Shown in US15
Also available in US3



CANOVA®
Shown in US15
Also available in US10BE, US19



SANTO®
Shown in US10BE
Also available in US15, US19

GRADE 2 & 3 LEVERS

BENNETT®

Grade 2 & 3
Shown in US10BE
Also available in US3, US5, US15,
US15A, AS



KENDALL®

Shown in US15
Also available in US15A, US10BE



NEWPORT®

Grade 2 & 3
Shown in US15
Also available in US15A, US10B,
US10BE



LEXINGTON®

Shown in US15
Also available in US3



SILONA®

Shown in AS
Also available in US26, US15,
US10BE



ASHEVILLE®

Shown in US15



FLORINI®

Shown in US10BE
Also available in
US15, US19



ARTINO®

Shown in US15
Also available in
US10BE, US19



SORADO®

Shown in US19
Also available in
US10BE, US15



ELECTRONIC LOCKS



KP300
Shown in US15



KP300 TOUCHSCREEN

DIGITAL DEADBOLT

Shown in US12P

Also available in US15, US19, US26

- Backlit Touch Screen for Nighttime Visibility
- Up To 6 Unique User Codes and 1 Master Code
- One-Time User Code
- Easy Management of User Codes
- Low Battery Alert
- Automatic Lock
- Auto-Stop Suspends Operation with 5 Incorrect Attempts
- Easy Installation, No Hard Wiring Needed

ELECTRONIC LOCKS



KP400 KEYPAD DEADBOLT GRADE 2

Shown in US15
Also available in US19

- Includes 2 Keys and 1 Remote Control (maximum 5 Remotes per unit)
- Up to 6 User Codes (4-10 digits in length)
- 1 Master Code for Function Set Up
- Equipped with Code Protection Function
- One-time Access Code Available
- Auto Lock Function (6 - 60 seconds)
- LED Illuminated Keypad for Nighttime Visibility
- Low Battery Alert
- Easy Installation, No Hard Wiring Needed
- One-Year Warranty for Electronic Components



LP250 KEYPAD LEVER LOCK

Available in US12P

- Includes 2 Keys and 1 Remote Control (maximum 5 Remotes per unit)
- Up to 6 User Codes (4-10 digits in length)
- 1 Master Code for Function Set Up
- Equipped with Code Protection Function
- One-time Access Code Available
- Auto Lock Function (6 - 60 seconds)
- LED Illuminated Keypad for Nighttime Visibility
- Low Battery Alert
- Easy Installation, No Hard Wiring Needed
- One-Year Warranty for Electronic Components

AVAILABLE
FINISHES



US12P
TUSCANY
BRONZE



US15
SATIN
NICKEL



US19
BLACK



US26
POLISHED
CHROME

BARN DOOR HARDWARE



Add a distinctive, stylish upgrade to your home while optimizing space with barn doors. Our Barndoor hardware is available in variety of styles and quality finishes with smooth, quiet wheels and durability to hold up to 330lbs.

FLAT TRACK BARN DOOR SERIES

1000 SERIES STANDARD

Available in Black, Satin Nickel, Brushed Steel, Bronze, and custom finishes



3000 SERIES TOP MOUNT

Available in Black



FLAT TRACK BARN DOOR SERIES

5000 SERIES WAGON WHEEL

Available in Black



5000 SERIES WAGON WHEEL



1000 SERIES STANDARD



3000 SERIES TOP MOUNT



PULLS & HANDLES

Delaney offers a variety of styles and finishes in handles as well as many barndoor accessories such as soft close and floor guides. Please see our full offering at DelaneyHardware.com

See website for all finish options



8-11/16"
FLUSH
PULL
PLATE



6-1/2"
PULL
HANDLE
SQUARE
0124



7"
PULL
HANDLE
CLOVER



15-3/4"
SINGLE-SIDED
ROUND
*Also available in
double-sided*



17-1/4"
SINGLE-SIDED
SQUARE
*Also available in
double-sided*



7-3/4"
FLAT
SQUARE



7-3/4"
PULL HANDLE
TUBULAR H32



7-3/4"
PULL HANDLE
ROUND 002



7-3/4"
PULL HANDLE
ROUND 036



10-1/4"
PULL HANDLE
SPADE



11-3/4"
PULL HANDLE
ROUND WITH PLATE



11-13/16"
FLUSH PULL WITH ROUND
HANDLE COMBO



5FT
SINGLE-SIDED
SQUARE
*Also available in
double-sided*

BATH HARDWARE



1100 & 900 SERIES

1100 SERIES

Shown in US4

Also available in US15, US19, US26, US12P

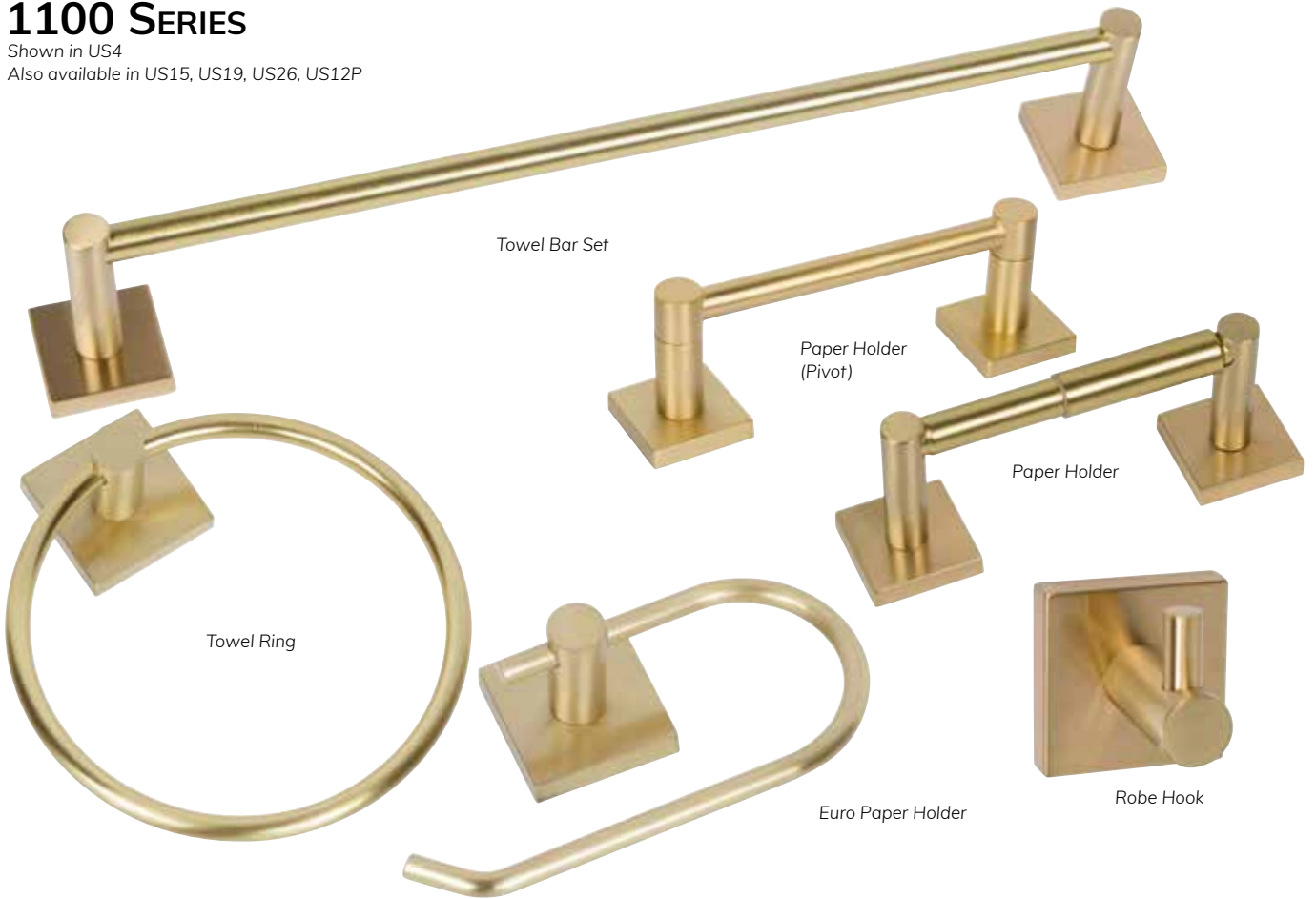

900 SERIES

Shown in US19

Also available in US4, US15, US26, US12P



800 & 700 SERIES

800 SERIES

Shown in US12P
Also available in US15, US26



700 SERIES

Shown in US26
Also available in US4, US15, US12P, US19



600 & 500 SERIES

600 SERIES

Shown in US15
Also available in US26, US12P



500 SERIES

Shown in US19
Also available in US4, US12P, US15, US26



400 & 300 SERIES

400 SERIES

Shown in US26
Also available in US15, US12P



Towel Bar Set

Paper Holder

Towel Ring

Euro Paper Holder

Robe Hook

300 SERIES

Shown in US15
Also available in US26, US12P

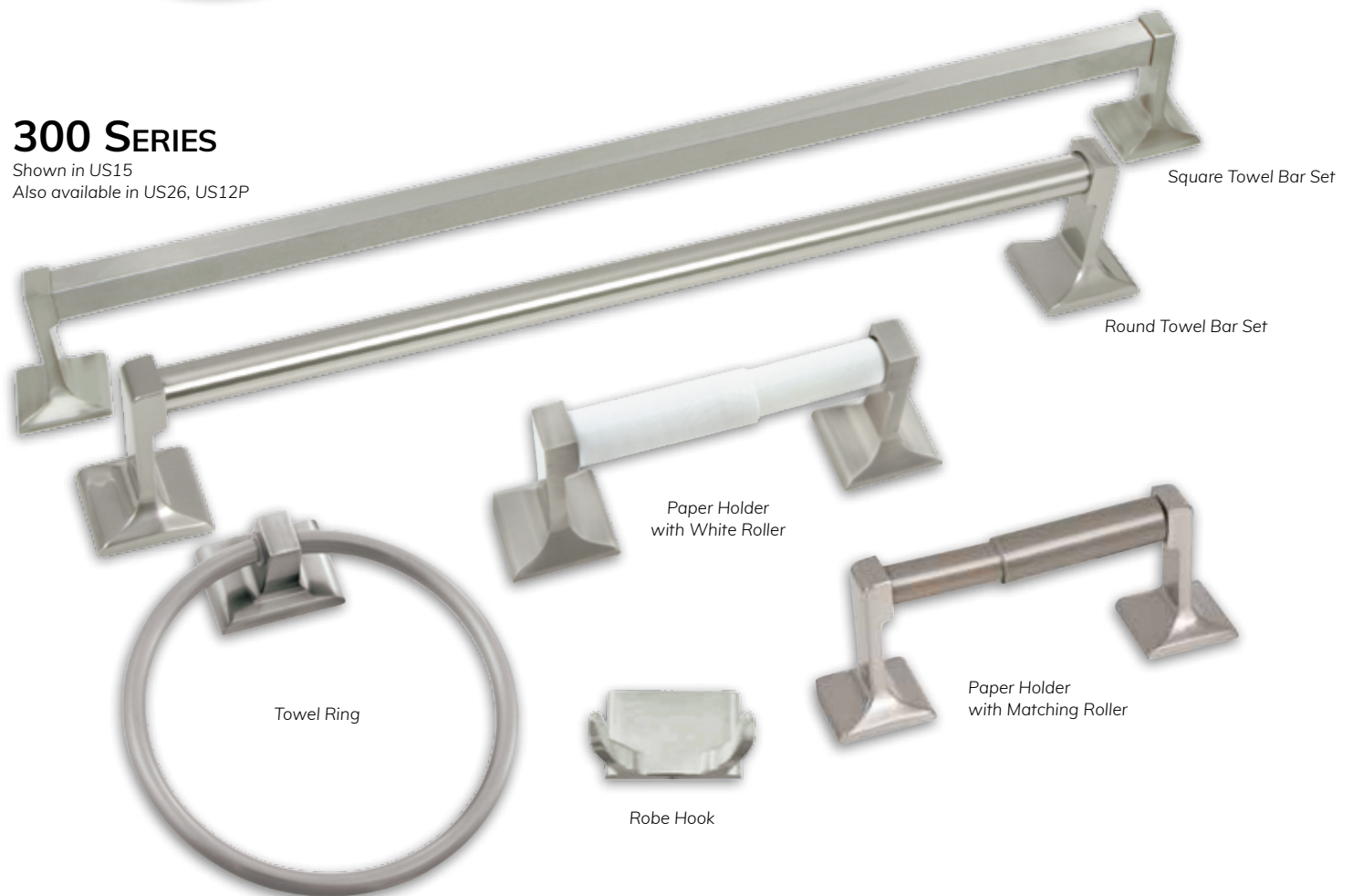

Square Towel Bar Set

Round Towel Bar Set

Paper Holder
with White Roller

Towel Ring

Robe Hook

Paper Holder
with Matching Roller

200 SERIES & ACCESSORIES

200 SERIES

Shown in US26



Towel Ring



Towel Bar Set



Paper Holder
with White Roller

BATH ACCESSORIES

Framed Medicine
Cabinet



Concealed Screw Grab Bar
Available in US32D



Shower Rod Set
Available in US26



Curve Shower Rods
Available in US26, US19

Constant
Curve Shower Rods
Available in US15, US26, US19

BUILDER'S HARDWARE



Builder's Hardware & Hinges

Pocket Door Locks	47
Door Knockers & Viewers.....	48
Kick Plates	48
Exterior Shutter Hardware	49
Handrail Brackets	50
Flush Bolts	50
Door Stops.....	51-52
Closet Hardware	53
Hinges.....	54

Trim hardware and hinges are available in multiple finishes. Please refer to the Technical Specifications on the DelaneyHardware.com website for available finishes for each product.

POCKET DOOR LOCKS



**CONTEMPORARY SQUARE
PASSAGE POCKET LOCK**
Shown in US15
Also available in US26, US19



**ROUND PRIVACY
POCKET DOOR LOCK**
Shown in US10B
Also available in US15, US19



**ROUND PASSAGE
POCKET DOOR LOCK**
Shown in US15
Also available with US10B, US19



**CONTEMPORARY SQUARE
PRIVACY POCKET LOCK**
Shown in US19
Also available in US15, US26



**SQUARE PRIVACY
POCKET DOOR LOCK**
Shown in US19
Also available in US15, US26



**CONTEMPORARY SQUARE
ENTRANCE POCKET LOCK**
Shown in US26
Also available in US15, US19



**SQUARE PASSAGE
POCKET DOOR LOCK**
Shown in US15
Also available in US19, US26



DOOR KNOCKERS & VIEWERS



4" DOOR KNOCKER WITH VIEWER

Also available with UL viewer
Shown in US15



160° UL VIEWER

Shown in US15
Also available in US3,
US10B, US19



180° DOOR VIEWER

Shown in US15
Also available in
US10B, US19



200° UL VIEWER

Shown in US15
Also available in US10B



4" BLACK HOUSE NUMBERS

Shown in US19

KICK PLATES

**STAINLESS STEEL
KICK PLATE**

Available in 6" x 34" or 8" x 34" sizes.

6" x 34"

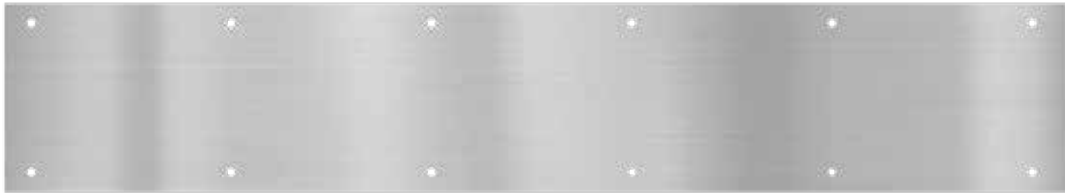

8" x 34"

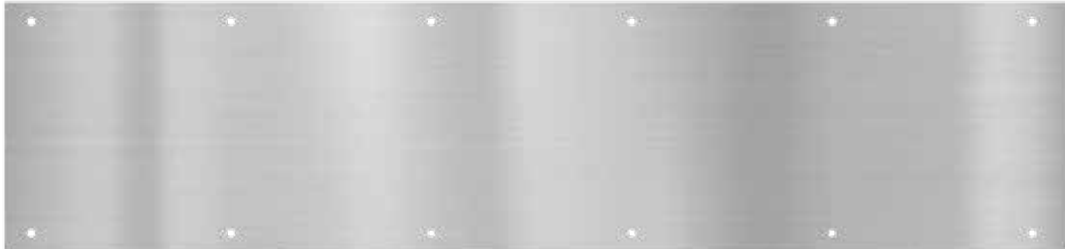

EXTERIOR SHUTTER HARDWARE



EXTERIOR SHUTTER HINGE SET
Shown in US19



FOR WOOD



FOR BRICK



FOR STONE

SHUTTER S HOOK



HANDRAIL BRACKETS

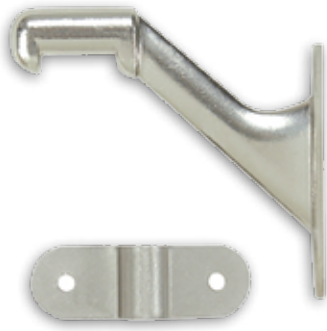

3" HANDRAIL BRACKET

Shown in US15
Also available in US3, US10B, US15A, US26



3-1/2" HANDRAIL BRACKET

Shown in US10B
Also available in US3, US15, US19, US26



DECORATIVE HANDRAIL BRACKET

Shown in US15
Also available in US10B, US19



FLUSH BOLTS



6" FLUSH BOLT ROUND

Shown in US10B
Also available in US15



6" FLUSH BOLT SQUARE

Shown in US15
Also available in US10B



7" MORTISE-IN FLUSH BOLT

Shown in US15
Also available in US10B

MORTISE-IN EXTENSION FLUSH BOLT

Shown in US26
Also available in US10B

DOOR STOPS



**3^{3/4}"
SPRING STOP**
Shown in US15
Also available in US15A, US10B



**3" JUMBO
SPRING STOP**
Shown in US15
Also available in US3, US5, US15A,
US10B, US19



**3" HEAVY DUTY
RIGID STOP**
Shown in US15
Also available in US3, US5,
US15A, US10B, US19



**3" 1-PIECE
SPRING STOP**
Shown in US15
Also available in US15A, US10B



DOOR SAVER II
Shown in US15
Also available in
US10B, US19, US26



DOOR SAVER 3
Shown in US15
Also available in US10B,
US19, US26



HEAVY DUTY HINGE PIN STOP
Shown in US15
Also available in US3, US5,
US15A, US10B, US19



DOOR SAVER HINGE PIN STOP
Shown in US10B
Also available in US3, US5,
US15, US15A, US19

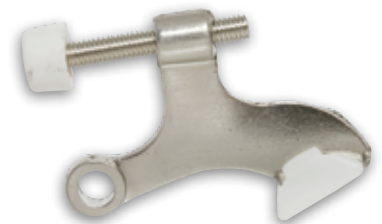

HALF LEAF PIN STOP
Shown in US15
Also available in US10B, US19

DOOR STOPS & GUARDS



2-3/4" FLOOR STOP
 Shown in US26D
 Also available in US10B



2-1/8" FLOOR STOP
 Shown in US26D
 Also available in US10B



HIGH PROFILE DOME STOP
 Shown in US26D
 Also available in US10B



LOW PROFILE DOME STOP
 Shown in US26D
 Also available in US10B



DROP DOWN DOOR HOLDER
 Shown in US26D

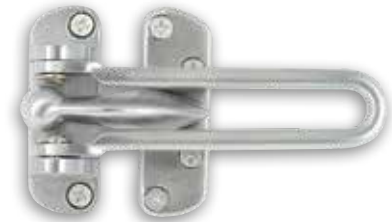

SAFETY DOOR GUARD
 Shown in US26D



1" WALL BUMPER
 Shown in US26D



2-1/4" WALL BUMPER
 Shown in US26D
 Also available in US15, US10B



2-1/8" & 3" KNOB PROTECTOR PLATE
 Shown in White



CHAIN DOOR STOP WITH VINYL COVER
 Shown in Zinc

CLOSET HARDWARE



MORTISE BALL CATCH

Shown in US15
Also available in US10B



DRIVE-IN BALL CATCH

Shown in US15
Also available in US3, US10B, US19, US26



JUMBO ROLLER CATCH

Shown in US26D
Also available in US10B



BI-FOLD KNOB

Shown in US15

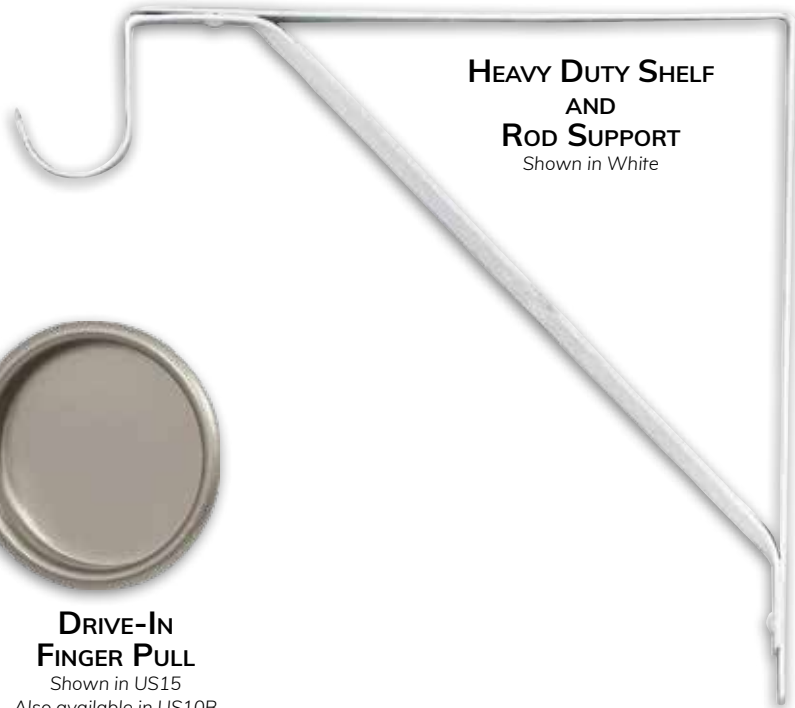

**HEAVY DUTY SHELF
AND
ROD SUPPORT**

Shown in White



**BI-FOLD KNOB
WITH BACK PLATE**

Shown in US15



**DRIVE-IN
FINGER PULL**

Shown in US15
Also available in US10B



**METAL CLOSET
POLE SOCKETS**

Shown in US26D



**PLASTIC CLOSET
POLE SOCKETS**

Shown in White



ADJUSTABLE CLOSET ROD

Shown in Zinc

HINGES



3 1/2" (5/8R) HINGE
Shown in Black



3 1/2" (5/8R) BALL BEARING HINGE
Shown in US15



4" (5/8R) HINGE
Shown in US10B



4" (5/8R) BALL BEARING HINGE
Shown in US10B



4" (5/8R) x SQ HINGE
Shown in US26D



4" SPRING HINGE
Shown in US26D



4" SPRING HINGE
Shown in US26D
Also available in 5/8" Radius



4" BALL BEARING HINGE
Shown in US26D



4" NRP BALL BEARING HINGE
Shown in US26D



4 1/2" BALL BEARING HINGE
Shown in US32D
Also available NRP



4 1/2" PLAIN BEARING HINGE
Shown in US26D



4 1/2" SPRING HINGE
Shown in US26D

MULTI-FAMILY / COMMERCIAL



Multi-Family / Commercial Hardware Solutions

Multi-Family Smartlock	56
Locksets	57-58
Deadbolts	59-60
Exit Devices	61-62
Exit Device Trims	63
Door Closers	64



Exterior

Interior



NEW MULTI-FAMILY SMARTLOCK

This ideal resident smart entry solution features a sleek design, higher encryption security, enhanced features, and seamless Stratis system integration.

- Bluetooth Low Energy (BLE) connectivity
- UL listed A156.12 & ANSI Grade 2 certified / ADA compliant
- Keyless Entry with tamperproof design (100% bump & pick proof)
- Fully Integrated with Stratis IoT (“Cloud-based” Management Access Control) Platform
- Smart MIFARE Plus access credential with AES 128 or Smartphone App (13.56 MHZ frequency)
- Data-on-card (no Gateways required – “NO-TOUR” functionality)
- 50 individual active users / 2,000 of revoked users
- Hassle-free user management (adding & deleting users)
- 9V Temporary Power Terminal for back up
- Audit trail captures up to 15,000 transactions
- LED Color-coded light & sound indicators
- Built Specifically for Multi-family & Student Housing

CYLINDRICAL LEVERSETS

GRADE 1 F SERIES / GRADE 2 E SERIES

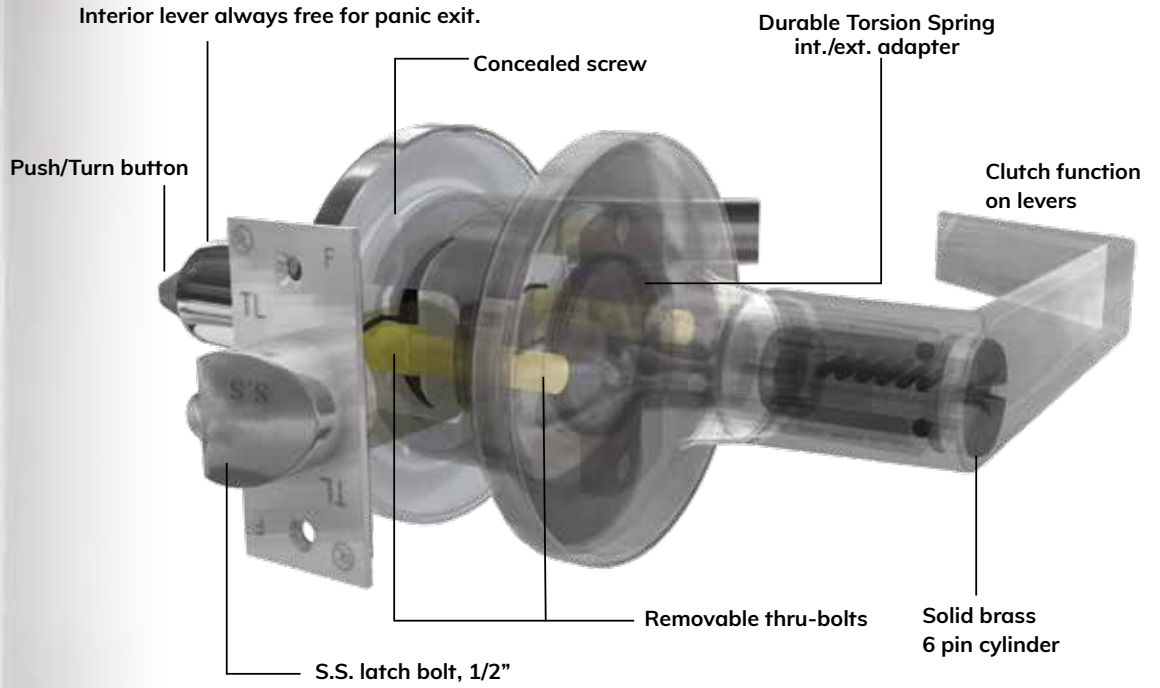

CT LEVER
F Series
Available in US26D



SD LEVER
F Series
Available in US26D



MD LEVER
F Series available in US26D
E Series available in US26D, US10B, & US19



GRADE 2 TUBULAR LEVERSETS

RH SERIES



CT LEVER
Shown in US26D
Also available in US10B



CT LEVER
Shown in US10B
Also available in US26D



REGENCY LEVER
Shown in US15



ANSLEY® KNOB
Shown in US12P
Also available in US15

GRADE 1 DEADBOLT

LM SERIES



Shown in US26D

GRADE 2 DEADBOLT

LU SERIES

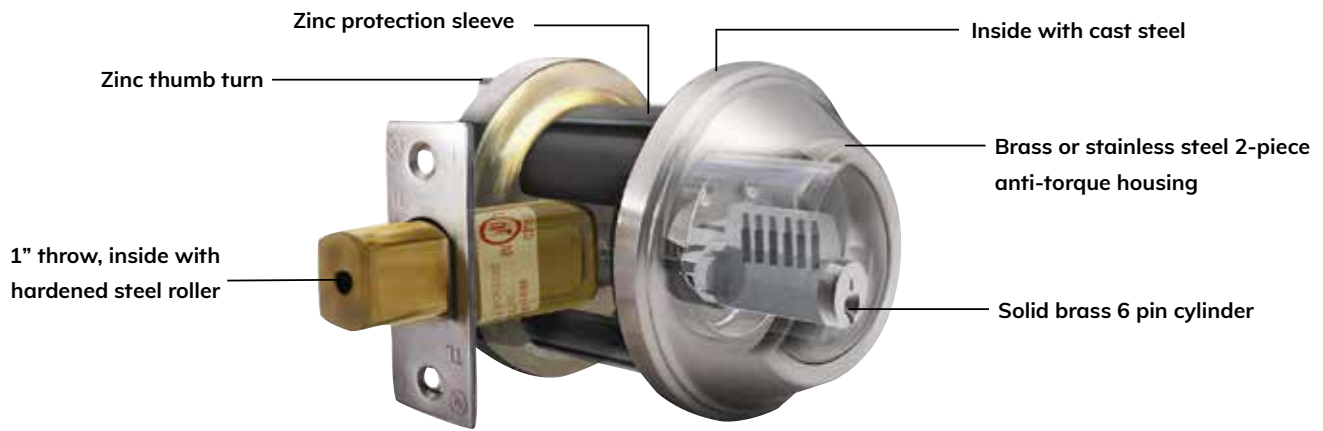

**(SFIC) INTERCHANGEABLE CORE DEADBOLT
(LU-RC)**

Shown in US32D
Available in US26D, US19



Shown in US19

GRADE 1 HEAVY DUTY EXIT DEVICES

RIM TYPE & VERTICAL ROD EXIT DEVICES

9000 SERIES



Shown in US32D
Also available in US28



9100/F9100 FIRE RATED



9100 available in US28
F9100 available in US32D



F9000 FIRE RATED



Shown in US32D



GRADE 1 EXIT DEVICES

RIM TYPE & VERTICAL ROD EXIT DEVICES

8000 SERIES 
Shown in US28
Also available in US19, US32D



8100/F8100 FIRE RATED 
8100 available in US32D
F8100 available in US28, US32D, US19, Duro



F8000 FIRE RATED 
Shown in US19
Also available in US28, US32D, Duro



EXIT DEVICE TRIMS

700 SERIES ESCUTCHEON LEVER TRIM



700ETL/ 704ETL
ENTRANCE OR NIGHT LATCH
FUNCTION (with Mortise Cylinder)
 Shown in US32D

500 SERIES LEVER TRIM

Shown in SD Lever Style. CT, SD, & MD styles also available



500L/504L
ENTRANCE OR NIGHT
LATCH FUNCTION
 Shown in US26D
 Also available in US10B, US19



501L
PASSAGE
FUNCTION
 Shown in US26D
 Also available in US10B, US19

AUTOMATIC FLUSH BOLTS

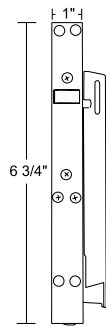
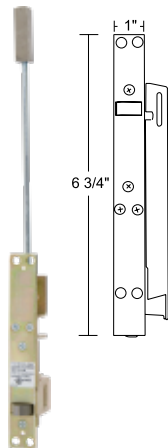

AFB-01
FOR METAL DOOR
(PAIR)

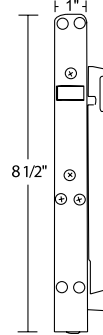
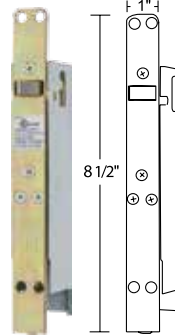

AFB-02
FOR WOOD DOOR
(PAIR)

FIRE DOOR COORDINATORS



DOOR CLOSERS

8000 / 8000-DA HEAVY DUTY (GRADE 1)

Shown in US28
Also available in Duro



All Exit Devices Are



6000 SERIES MEDIUM-HEAVY DUTY (GRADE 1)

Shown in US19
Also available in US28, Duro



4400 SERIES LIGHT-MEDIUM DUTY (GRADE 1)

Available in US28



3000 SERIES LIGHT DUTY (GRADE 2)

Shown in US28
Also available in Duro



AVAILABLE FINISHES



US3
POLISHED BRASS



US4
SATIN BRASS



US5
ANTIQUÉ BRASS



US10B
OIL RUBBED
BRONZE



US10BE
EDGED OIL RUBBED
BRONZE



ABR (USD10B)
AGED BRONZE



US12P
TUSCANY BRONZE



US15
SATIN NICKEL



US19
BLACK



ABK
AGED BLACK



US26
POLISHED CHROME



US26D
DULL CHROME



US28 (AL)
ALUMINUM



US32D
STAINLESS STEEL



AS
ANTIQUÉ SILVER



DURO
DURO BRONZE

HANDING INSTRUCTIONS

Standing OUTSIDE the private area, regardless of whether the door swings towards you or away from you, if the Hinges are on the left, order a Left Hand (LH) lock. Likewise, if the Hinges are on the right, order a Right Hand (RH) lock.

INSWING DOOR

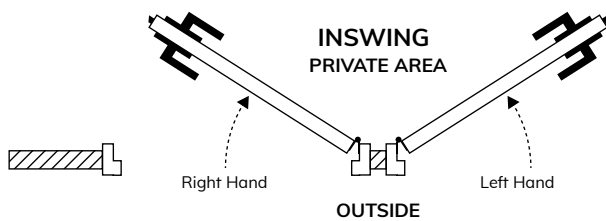

OUTSWING DOOR

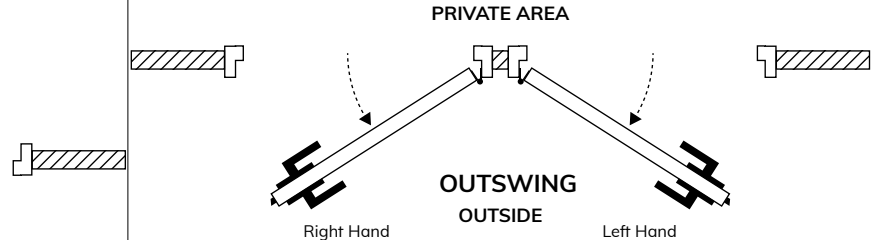





DELANEY®

BRAVURA • DELANEY • CALLAN



DelaneyHardware.com | 800.952.4430

LITCATALOG – Revised August 2022